









LEYENDA

	Ámbito MM La Vistilla	36.770,35 m ²
SUELO URBANO		
	Delimitación de Suelo Urbano Consolidado (SUICO)	32.009,82 m ²
	Viales	5.821,72 m ²
	Aparcamientos	148,75 m ²
	Rodiales	720,30 m ²
	Paseos peatonales	331,42 m ²
	Sentidos de circulación	
SUELO RÚSTICO DE PROTECCIÓN ECONÓMICA		
	Suelo Rústico de Protección Agraria 2 (SRPAG-2)	4.760,53 m ²

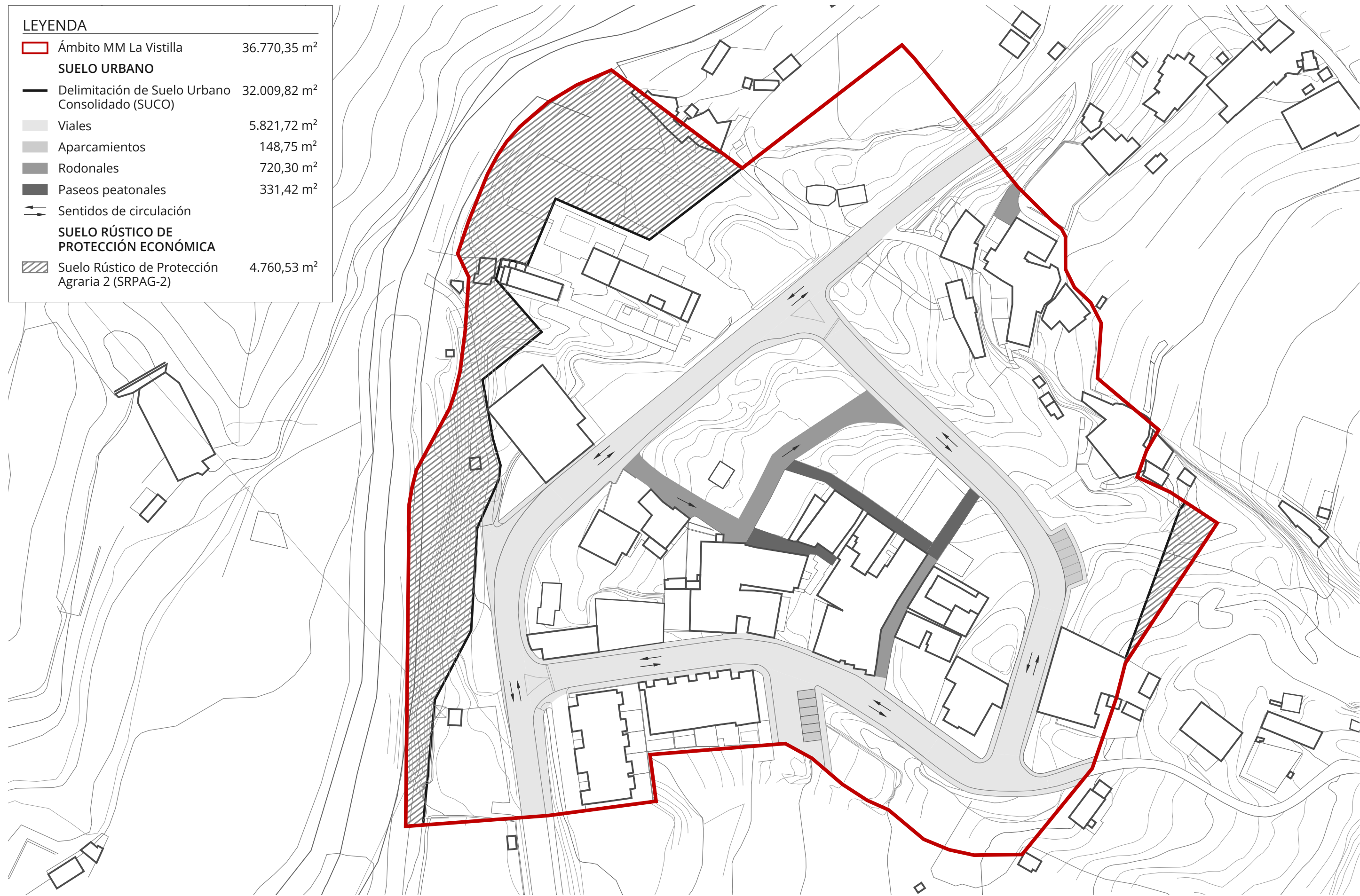

Alternativa 1_Red viaria